

HGP Japanese Language Program

Orientation

Beginner High

Hitotsubashi Center for Global Education

7

1. General Information on Classes

11

Intermediate Low

Beginner High

Beginner Low

12

Course steps

Beginner Low → Beginner High → Intermediate Low → Intermediate High

If you successfully pass courses at the level you were placed in, you will be eligible to take courses at a higher level in the following semester.

13

Classes will be conducted face-to-face.

- In principle, classes will be conducted face-to-face.
- Students who have not yet entered Japan or have been officially permitted to attend classes online by Hitotsubashi University may take classes online.
- Depending on the situation, the mode of class delivery may change by consultation.

14

2. Course Registration

15

一橋大学
Hitotsubashi University

Course Registration Period

**Friday, September 8 –
Friday, September 15**

16

一橋大学
Hitotsubashi University

Course Enrollment Web Lottery

Decisions regarding the enrollment of Exchange students will be made by the web lottery.

First Web Lottery:
9:00 September 4 – 12:00 September 5

Second Web Lottery:
17:00 September 6 – 14:00 September 7

For details, contact the administration office.

17

一橋大学
Hitotsubashi University

How to register

- Register via **Campus Education Learning System** online. 
- Undergraduate Exchange Students** may apply to the First and Second Web Lottery.
- Graduate Exchange Students, Research Students, and Regular Graduate Students** may apply only to the **Second Web Lottery**.

18

一橋大学
Hitotsubashi University

How to Register

		Via CELS	1 st lottery	2 nd lottery
Exchange Students	Under-graduate	○	○	○
	Graduate	○	×	○
Regular Graduate Students		○	×	○
Research Students		○	×	○

19

一橋大学
Hitotsubashi University

How to Access: CELS

→ **HU homepage** → **Current Students**

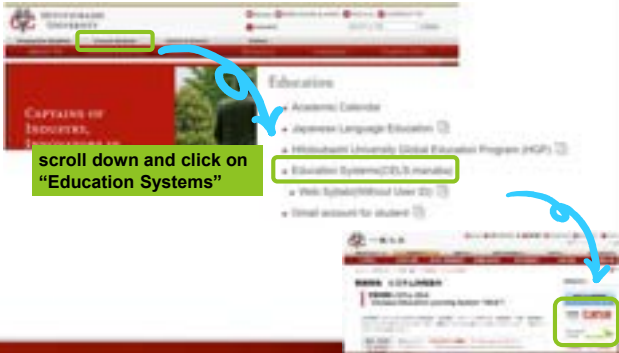

scroll down and click on "Education Systems"

22

一橋大学
Hitotsubashi University

Withdrawal (W) of your registered course(s)

If you have registered for a course and decided to withdraw from it after the registration period, you must process the withdrawal using the CELS Online Registration System during the withdrawal period. **After that period, you will not be able to withdraw.** Failure to complete the assigned (assessment) tasks will result in a **Fail grade (F)**.

Course Withdrawal:
Tuesday, September 26 – Monday, October 2

23

一橋大学
Hitotsubashi University

First Week Classes

Classes will be provided face-to-face.

Come to the classroom and bring a PC with you.

24

一橋大学
Hitotsubashi University

日本語学習
manaba

Self-registration on manaba

Hitotsubashi Center for Global Education
Japanese Language Education Program

27

一橋大学
Hitotsubashi University

- Self-registration on **MANABA** is different from the **CELS** course registration. **To enroll in the course as a regular student, you should complete the course registration procedure on CELS.**
- Students who win the Web Lottery will be automatically registered on **MANABA**.

NOTE! After the registration period is closed, all students except students enrolled in the course will **be automatically** deleted from **MANABA**.

28

一橋大学
Hitotsubashi University

Professors will post important news on **MANABA**.

Adjust the reminder settings to receive announcements via email.

- ★ Make sure you have Hitotsubashi Student ID and the password

30

一橋大学
Hitotsubashi University

Click the tab "Current Students" on Hitotsubashi University homepage



33

一橋大学
Hitotsubashi University

Click "Education Systems (CELS, manaba)"



34



35



36

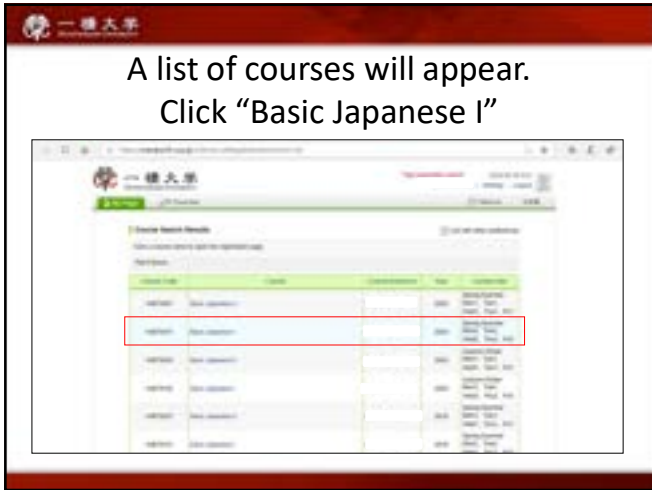

38

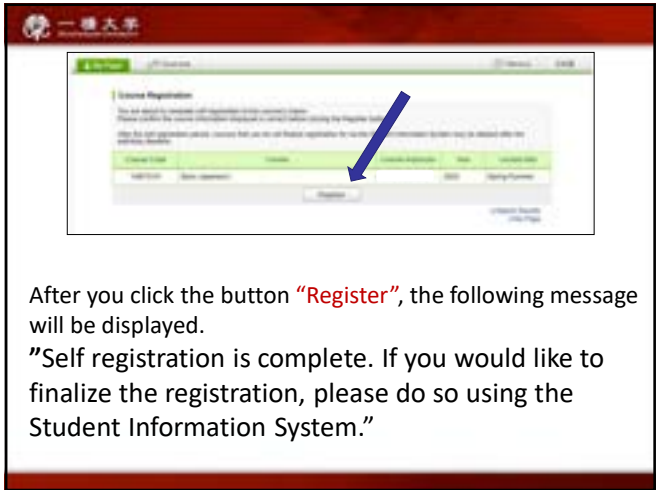

39

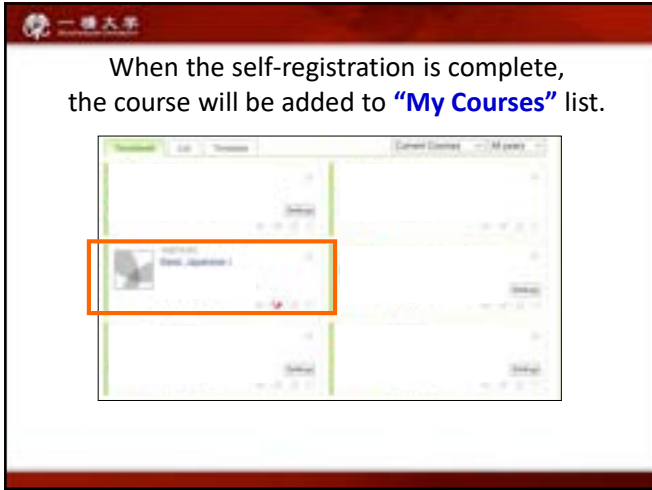

40

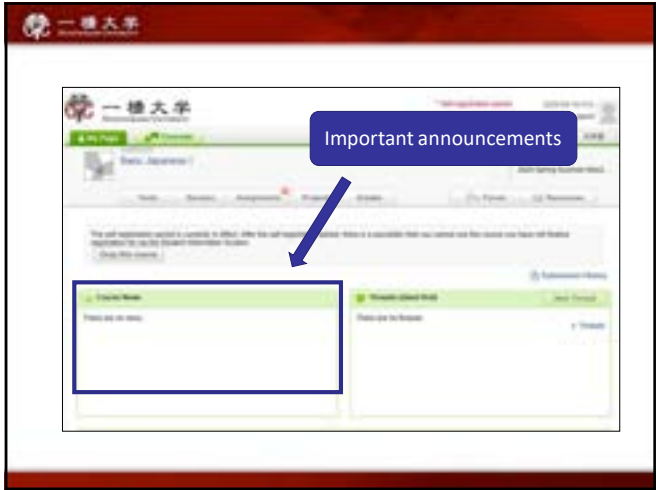

42



43

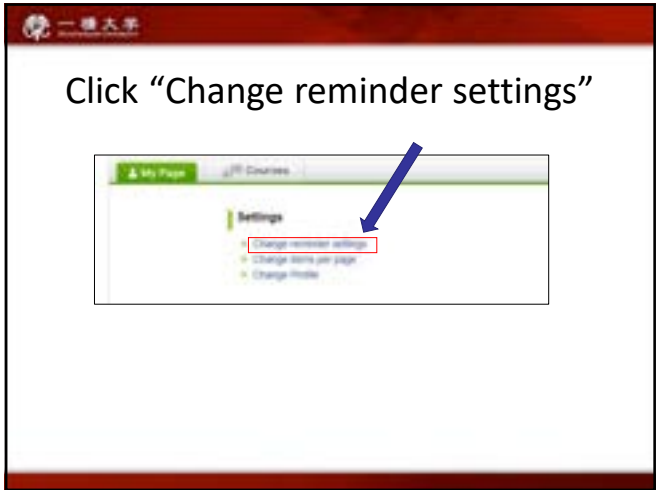

44

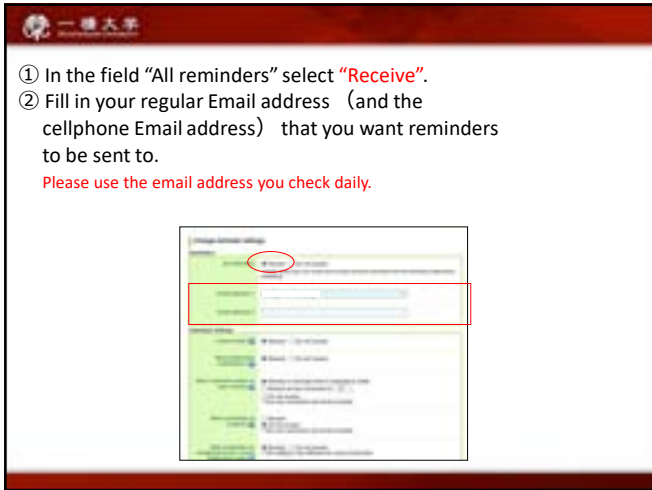

45

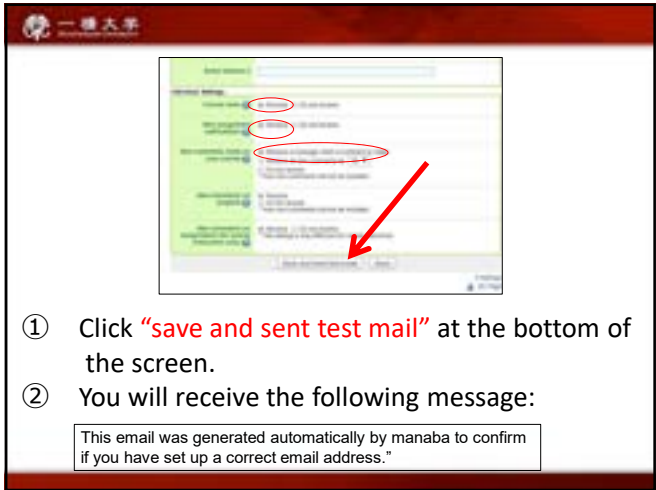

46



47



65

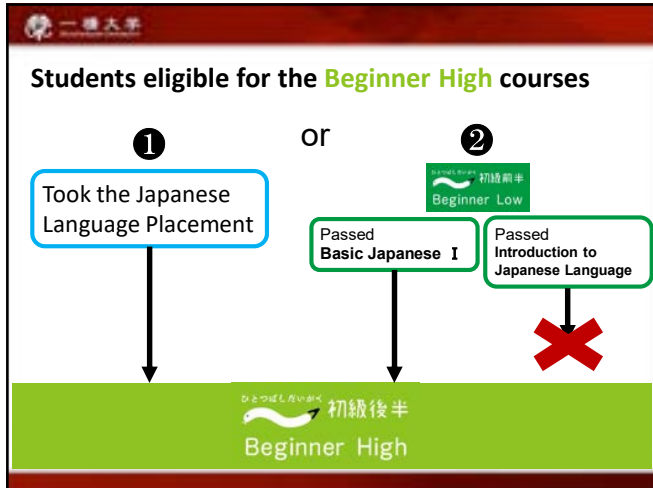

66

Basic Japanese II

- an intensive course
- 5 classes per week (5 credits)
- designed for students who want to learn the Japanese language intensively and major in the Japanese language at their home universities.

Comprehensive Japanese for Beginners

- a light course
- 3 classes per week (3 credits)
- designed for students who plan to study at Hitotsubashi University for 1 semester or more and want to learn Japanese at a slow pace.

67

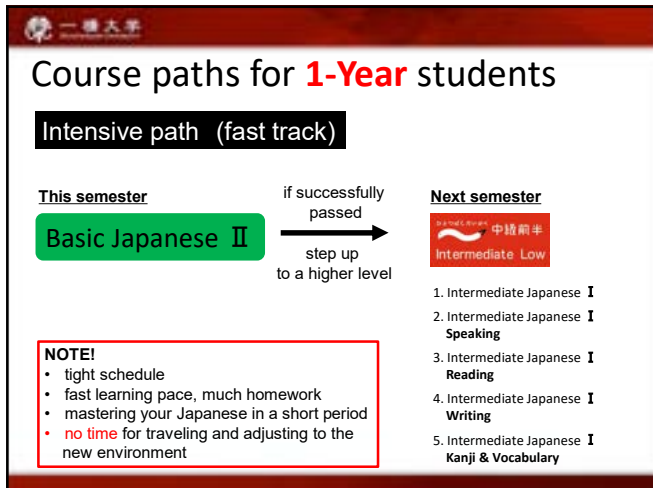

68

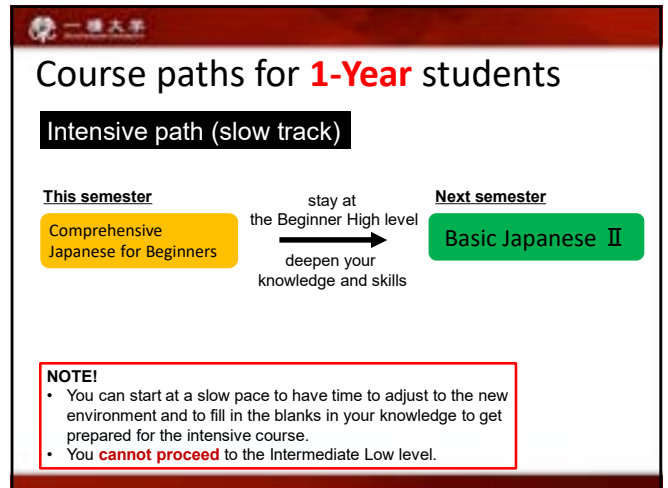

69

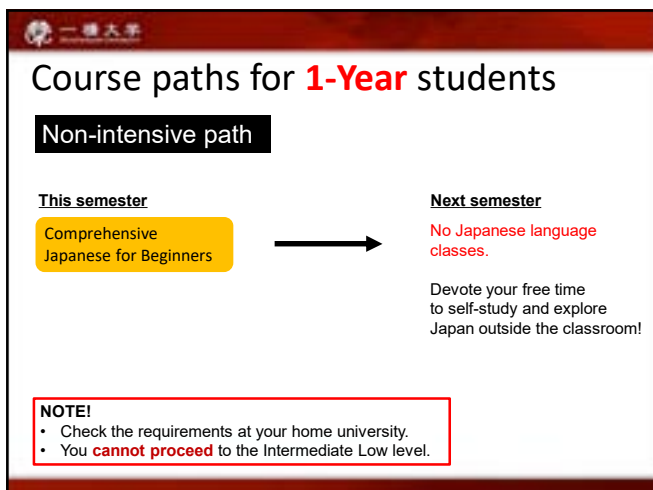

70

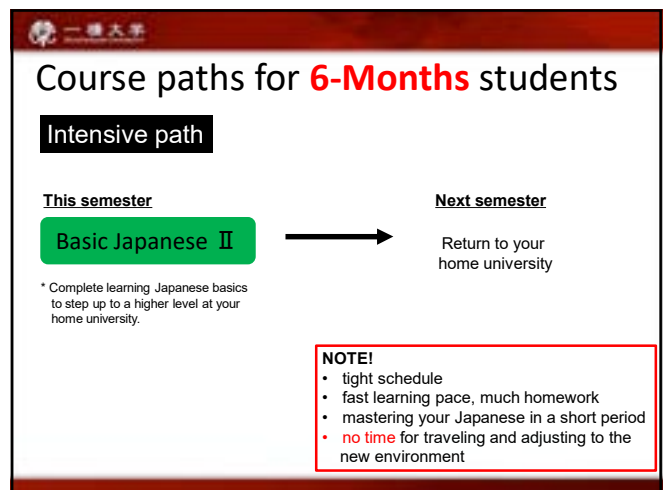

71

一橋大学
Hitotsubashi University

Course paths for 6-Months students

Non-intensive path

This semester
Comprehensive Japanese for Beginners
* Broaden your knowledge in Japanese basics and improve your skills at a slow pace.

→

Next semester
Return to your home university

NOTE!
• Check the requirements at your home university.

72

一橋大学
Hitotsubashi University

Basic Japanese II

VS.

Comprehensive Japanese for Beginners

73

一橋大学
Hitotsubashi University

Course Instructors

Course Coordinator ツオイ エカテリーナ
tsoy.e@r.hit-u.ac.jp
Office Hour: by appointment

Other Instructors

Basic Japanese II	Comprehensive Japanese for Beginners
志村 ゆかり 中川 純子 杉本 美穂 山崎 真弓	鳥 益智 岡 登幹

74

一橋大学
Hitotsubashi University

3.1 Timetable

75

一橋大学
Hitotsubashi University

Course Period: September 11 – December 22

	Mon	Tue	Wed	Thu	Fri
1st 8:45 - 10:30	BJ II	BJ II	BJ II		CJB
2nd 10:45 - 12:30	CJB		CJB	BJ II	BJ II

76

一橋大学
Hitotsubashi University

Basic Japanese II	Comprehensive Japanese for Beginners
<ul style="list-style-type: none"> • 5 classes per week (5 credits) • Students should attend <u>all 5 classes.</u> 	<ul style="list-style-type: none"> • 3 classes per week (3 credits) • Students should attend <u>all 3 classes.</u>

★ Students are **not allowed** to take both courses during the same semester.

77

一橋大学

3.2 Textbooks

78

一橋大学

Basic Japanese II

Comprehensive Japanese for Beginners



should be purchased



optional



should be purchased

Textbooks and workbooks are available at the Hitotsubashi Coop bookstore on West Campus.

79

一橋大学

1. "GENKI Vol.2: An Integrated Course in Elementary Japanese (Third Edition) "
The Japan Times, ¥3600+tax,
ISBN: 978-4-7890-1732-9



↑
should be purchased

2. **OPTIONAL**
"GENKI Vol.2 WORKBOOK (Third Edition) "
The Japan Times, ¥1700+tax,
ISBN-13: 978-4-7890-1733-6



↑
optional



NOT the 2nd Edition!

80

一橋大学

1. "Marugoto: RIKAI Elementary 2 (A2)"
The Japan Foundation, Sanshusha.
1900 yen + TAX
ISBN: 978-4-384-05757-7



↑
should be purchased

2. Listening materials, supplementary materials for "Marugoto: Rikai Elementary 2 (A2)"
Digital audio files, Vocabulary index, etc. (for FREE)
https://www.marugoto.org/en/download/elementary2_c/



NOT "KATUDOO"

81

- 一橋大学
- Supplementary materials will be distributed before classes via MANABA.
 - ★ Students should check the MANABA course page and download handouts before each class.
 - Copies of textbooks will be distributed in class (only for the first week).
Regular students enrolled in the course **MUST** purchase textbooks as soon as possible.

88

一橋大学

3.3 Schedule

89

一橋大学

Course Description Materials

Download the course description materials from the “Resources” on the **manaba** course page.

1. Autumn-Winter Semester 2023 Syllabus
2. Autumn-Winter Semester 2023 Schedule
3. “How To” materials

90

一橋大学

☞ Download the schedules from the “Resources” on the BJ2 or CJB manaba course page.

Use the class schedules to:

- preview lessons;
- get prepared for quizzes;
- submit assignments on time;
- manage your time effectively.

★ Class schedules may be subject to change.

91

一橋大学

3.4 Grading

93

一橋大学

Basic Japanese II		Comprehensive Japanese for Beginners	
Final Exam, Final Video	30%	Final Exam, Presentation	30%
Midterm Exam	20%	Midterm Exam	20%
Homework	10%	Homework (Grammar Exercises)	20%
<small>(Writing Assignments, Shadowing)</small>			
Grammar Quizzes	10%	Vocabulary & Kanji Quizzes	15%
Kanji Quizzes	10%		
Vocabulary Quizzes	10%		
Participation	10%	Participation	15%
100%		100%	

94

一橋大学

Attendance

- **No audit** is allowed. Students who want to attend Japanese learning classes are required to register.
- Being **absent or late** to class **will be penalized** with a total score reduction.
- Keep in touch with the class instructors if you have any problems with attendance.

95

一橋大学

Homework

- You will be given homework assignments on a regular basis. **Refer to the course schedule and meet deadlines.**
- You should submit your homework at the beginning of the class following the instructor’s directions. **No submission after the deadline is accepted.**
- Incomplete or incorrectly done homework will NOT be accepted and will be marked as 0.

97

一橋大学

Quizzes

- Quizzes will be held at the beginning of the class.
If you come late, you will miss the quiz.
- No make up for quizzes.

102

一橋大学

Exams

- You may make up for midterm and final exams **ONLY IF YOU HAVE SERIOUS CIRCUMSTANCES**. In this case, you must submit a written explanation and inform the **coordinator** as soon as you can.
- Makeup exams need to be taken within a week after the scheduled exam date and will NOT be offered before the original test dates. The score for a makeup exam will be decreased by 10 %.

103

一橋大学

- ALL the courses are taught using the “direct method,” which means that classes are conducted **only in Japanese.**
- **We have strict attendance rules.**
If students miss classes, it will be difficult to catch up and successfully finish the course.

104

一橋大学

FQA

How do we pre-register for the classes?

Submit “Students Information Sheet” on the manaba “Surveys” page.

**Only students who have already decided to take the class. It is not the official course registration.*

105

一橋大学

FQA

Can we attend various classes during the first week? (Just try them in order to decide which class I would take.)

▶ *Due to the registration system, YES.*
However, if you miss a class, you will need to catch up on the lesson content on your own, as there will not be any extra classes for catching up.

106

一橋大学

FQA

My major class conflicts with the Japanese class. (i.e., Japanese Economics and BJ2 both are scheduled on the same day and same period)
Is it possible to be absent from some classes in a week?

▶ **NO.** *You must attend all classes.*
(5 classes a week for BJ2 or 3 classes a week for CJB)

107

FQA

Can we apply for the web lottery for both BJ2 and CJB?

(In order to decide which class to take and opt-out during the withdrawal period)

▶ *Due to the registration system, Yes.*

BUT!

Applying for both BJ2 and CJB, you may deprive other students of the opportunity to take Japanese classes. To avoid causing such issues, please carefully read the course materials (syllabus and schedule) and choose only one.

108

5. FQA

Can we talk to teachers if we are unsure which class to take?

▶ *Yes. We will stay here after this orientation and answer your questions about the courses.*

*We will also have a course consultation from **13:30~14:30 on March 31** in the Mercury Tower 7F.*

109